

# HID-High Power ballasts for SON/MH lamps

## BSN 1000L 3021

Impregnated (HID standard) electromagnetic ballasts, of copper/iron construction, for use in combination with an external ignitor, for HID lamps

### Product data

General Information	
Application code	L302 I
Operating and Electrical	
Input Voltage	230 V
Input frequency	50 Hz
Power factor 100% load (min.)	0.85
Mains voltage performance (AC)	-8%~+6%
Mains voltage safety (AC)	-10%~+10%
Input current with PF correction	5.4 A
Input current without PF Correction	10.3 A
Power factor without PF compensation (nom.)	45
Power losses (nom.)	52 W
Wiring	
Connector type	Screw
System characteristics	
Rated ballast-lamp power	1000 W

Temperature	
T-winding (max.)	130 °C
Delta-T normal conditions	80 °C
Approval and Application	
Approval marks	CE marking CCC certificate
Product Data	
Full product code	694818229956700
Order product name	BSN 1000L 3021
EAN/UPC – product	6948182295385
Order code	913710106742
SAP numerator – quantity per pack	1
Numerator – packs per outer box	1
Material no. (12 NC)	913710106742
SAP net weight (piece)	8.700 kg

## HID-High Power ballasts for SON/MH lamps

### Dimensional drawing

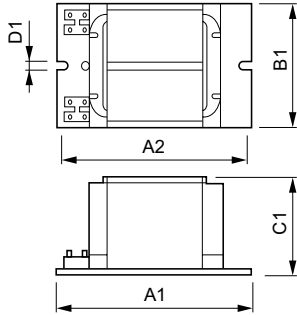

Product	D1	C1	A1	A2	B1
BSN 1000L 302I	7 mm	102.0 mm	183 mm	134.5 mm	117.0 mm

BSN 1000 L302 I

