



# HID-Basic ballasts for HPL and HPI(PLUS) lamps

## BHL 250L 200

The HID-Basic ballast is an impregnated (HID standard) electromagnetic ballast for HID lamps, for use in combination with an external ignitor.

### Product data

General Information	
Application code	L200
Operating and Electrical	
Input Voltage	220 V
Input frequency	50 Hz
Power factor 100% load (min.)	0.85
Mains voltage performance (AC)	-8%~+6%
Mains voltage safety (AC)	-10%~+10%
Input current with PF correction	1.35 A
Input current without PF Correction	2.13 A
Power factor without PF compensation (nom.)	0.55
Power losses (nom.)	17 W
Wiring	
Connector type	Screw
System characteristics	
Rated ballast-lamp power	250 W

Temperature	
T-winding (max.)	130 °C
Delta-T normal conditions	65 °C
Approval and Application	
Approval marks	CE marking CCC certificate
Product Data	
Full product code	694818229965900
Order product name	BHL 250L 200
EAN/UPC – product	6948182295293
Order code	913710100442
SAP numerator – quantity per pack	1
Numerator – packs per outer box	6
Material no. (12 NC)	913710100442
SAP net weight (piece)	2.000 kg

## HID-Basic ballasts for HPL and HPI(PLUS) lamps

### Dimensional drawing

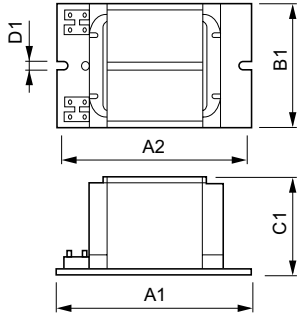

Product	D1	C1	A1	A2	B1
BHL 250L 200	6.2 mm	64.5 mm	125.0 mm	110.0 mm	75.5 mm

BHL 250 L200

