



# ET-S transformer

## ET-S 15 LED 220-240V

High-Frequency electronic transformer for operation with 12V halogen lamps, available in 70W, 105W and 150W versions

### Product data

General Information	
Type version	-
Lamp type	LV Halogen
Number of products on MCB (16 A type B) (nom.)	90
Automatic restart	Yes
Operating and Electrical	
Input Voltage	220 to 240 V
Input frequency	50 to 60 Hz
Power factor 100% load (nom.)	0.98
Mains voltage performance (AC)	202...254V
Mains voltage safety (AC)	198...264V
Inrush current width	0.10 ms
Power losses (nom.)	0.99 W
Inrush current peak (max.)	15 A
Output voltage	11.3 V
Wiring	
Connector type input terminals	Screw
Colour input terminals	Orange
Connector type output terminals	Screw
Cable length from device to lamp	1.0 m
Wire strip length	8.0-9.0 mm
Input terminal cross section	0.75-1.50 mm <sup>2</sup>

Output terminal cross section	0.75-1.50 mm <sup>2</sup>
System characteristics	
Rated ballast-lamp power	15 W
Temperature	
T-ambient (max.)	50 °C
T-ambient (min.)	-20 °C
T-Case maximum (max.)	65 °C
Approval and Application	
Approval marks	CE marking
Product Data	
Full product code	694793910315700
Order product name	ET-S 15 LED 220-240V
EAN/UPC – product	6947939103157
Order code	913710032479
SAP numerator – quantity per pack	1
Numerator – packs per outer box	50
Material no. (12 NC)	913710032479
SAP net weight (piece)	0.072 kg

## ET-S transformer

### Dimensional drawing

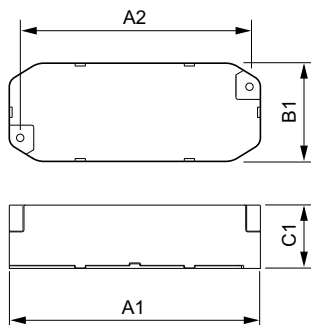

Product	D1	C1	B2	A1	A2	B1
ET-S 15 LED 220-240V	3.4 mm	29.0 mm	23.4 in	115.0 mm	105.0 mm	45.0 mm

ET-S 15 LED 220-240V 50/60Hz

