

# HID-High Power ballasts for SON/MH lamps

## BSN 1000L 3021

Impregnated (HID standard) electromagnetic ballasts, of copper/iron construction, for use in combination with an external ignitor, for HID lamps

### Product data

General Information		Temperature	
Application code	L302 I	T-winding (max.)	130 °C
		Delta-T normal conditions	80 °C
Operating and Electrical		Approval and Application	
Input Voltage	230 V	Approval marks	CE marking CCC certificate
Input frequency	50 Hz		
Power factor 100% load (min.)	0.85	Product Data	
Mains voltage performance (AC)	-8%~+6%	Full product code	697480505005500
Mains voltage safety (AC)	-10%~+10%	Order product name	BSN 1000L 3021
Input current with PF correction	5.4 A	EAN/UPC – product	6974805050055
Input current without PF Correction	10.3 A	Order code	913710106742
Power factor without PF compensation (nom.)	45	SAP numerator – quantity per pack	1
Power losses (nom.)	52 W	Numerator – packs per outer box	1
		SAP material	913710106742
Wiring		SAP net weight (piece)	8.700 kg
Connector type	Screw		
System characteristics			
Rated ballast-lamp power	1000 W		

## HID-High Power ballasts for SON/MH lamps

### Dimensional drawing

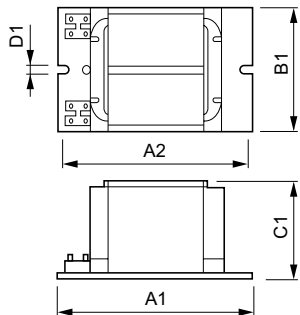

Product	D1	C1	A1	A2	B1
BSN 1000L 302I	7 mm	102.0 mm	183 mm	134.5 mm	117.0 mm

BSN 1000L 302I

