



# HID-Basic ballasts for HPL and HPI(PLUS) lamps

## BHL 125L 200

The HID-Basic ballast is an impregnated (HID standard) electromagnetic ballast for HID lamps, for use in combination with an external ignitor.

### Product data

General Information		Temperature	
Application code	L200	T-winding (max.)	130 °C
Operating and Electrical		Approval and Application	
Input Voltage	220 V	Approval marks	CE marking CCC certificate
Input frequency	50 Hz	Product Data	
Power factor 100% load (min.)	0.85	Full product code	871016303168230
Mains voltage performance (AC)	-8%~+6%	Order product name	BHL 125L 200
Mains voltage safety (AC)	-10%~+10%	EAN/UPC – product	8710163148540
Input current with PF correction	0.7 A	Order code	913710105050
Input current without PF Correction	1.15 A	SAP numerator – quantity per pack	1
Power factor without PF compensation (nom.)	0.55	Numerator – packs per outer box	6
Power losses (nom.)	12.2 W	SAP material	913710105050
Wiring		SAP net weight (piece)	1.190 kg
Connector type	Screw	System characteristics	
System characteristics		Rated ballast-lamp power	125 W

## HID-Basic ballasts for HPL and HPI(PLUS) lamps

### Dimensional drawing

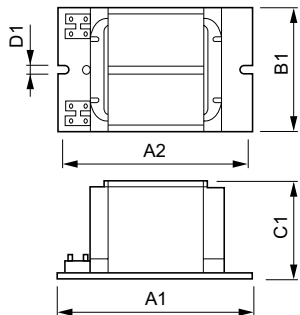

Product	D1	C1	A1	A2	B1
BHL 125L 200	6.2 mm	51.5 mm	117.0 mm	102.0 mm	57.1 mm

BHL 125 L200

