

HID-High Power ballasts for HPL and HPI lamps

BHL 1000L 202

The HID High-Power ballast is an impregnated (HID standard) electromagnetic copper/iron ballast for use with an external ignitor for HID lamps.

Product data

General Information	
Application code	L202
Operating and Electrical	
Input Voltage	230 V
Input frequency	50 Hz
Power factor 100% load (min.)	0.85
Mains voltage performance (AC)	-8%~+6%
Mains voltage safety (AC)	-10%~+10%
Input current with PF correction	5,3 A
Input current without PF Correction	7.5 A
Power factor without PF compensation (nom.)	60
Power losses (nom.)	39 W
Wiring	
Connector type	Screw
System characteristics	
Rated ballast-lamp power	1000 W

Temperature	
T-winding (max.)	130 °C
Delta-T normal conditions	75 °C
Approval and Application	
Approval marks	CE marking CCC certificate
Product Data	
Full product code	694818229967300
Order product name	BHL 1000L 202
EAN/UPC – product	6948182295354
Order code	913710104942
SAP numerator – quantity per pack	1
Numerator – packs per outer box	1
SAP material	913710104942
SAP net weight (piece)	6.900 kg

HID-High Power ballasts for HPL and HPI lamps

Dimensional drawing

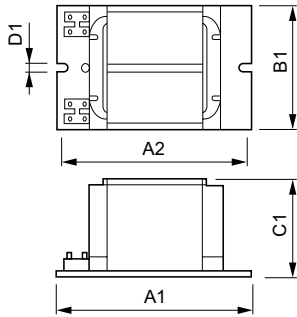

Product	D1	C1	A1	A2
BHL 1000L 202	7 mm	102.0 mm	165 mm	123 mm

BHL 1000 L202

