



HID-Basic ballasts for HPL and HPI(PLUS) lamps

BHL 250L 200

The HID-Basic ballast is an impregnated (HID standard) electromagnetic ballast for HID lamps, for use in combination with an external ignitor.

Product data

General Information		Temperature	
Application code	L200	T-winding (max.)	130 °C
Operating and Electrical		Delta-T normal conditions	65 °C
Input Voltage	220 V	Approval and Application	
Input frequency	50 Hz	Approval marks	CE marking CCC certificate
Power factor 100% load (min.)	0.85	Product Data	
Mains voltage performance (AC)	-8%~+6%	Full product code	697480505063500
Mains voltage safety (AC)	-10%~+10%	Order product name	BHL 250L 200
Input current with PF correction	1.35 A	EAN/UPC – product	6974805050635
Input current without PF Correction	2.13 A	Order code	913710100442
Power factor without PF compensation (nom.)	0.55	SAP numerator – quantity per pack	1
Power losses (nom.)	17 W	Numerator – packs per outer box	6
Wiring		SAP material	913710100442
Connector type	Screw	SAP net weight (piece)	2.000 kg
System characteristics			
Rated ballast-lamp power	250 W		

HID-Basic ballasts for HPL and HPI(PLUS) lamps

Dimensional drawing

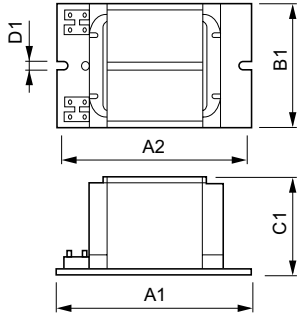

Product	D1	C1	A1	A2	B1
BHL 250L 200	6.2 mm	64.5 mm	125.0 mm	110.0 mm	75.5 mm

BHL 250 L200

