



Electronic ignitor for HID lamp circuits

SN 58 T15

HID ignitors for semi-parallel systems

Product data

General Information	
Application code	58 T15
Operating and Electrical	
Input Voltage	220 to 240 V
Input frequency	50 to 60 Hz
Ignition type	Semi-Parallel
Ignition time (max.)	18 s
Ignition time (min.)	12 s
Ignition time (nom.)	15 s
Ignition voltage (max.)	5.0 kV
Ignition voltage (min.)	2.8 kV
Response voltage	195 V
Mains voltage performance (AC)	-8%+6%
Mains voltage safety (AC)	-10%+10%
Power losses (nom.)	1 W
Wiring	
Ballast contact wire cross section	0.50-2.50 mm ²
Connector type	Screw
Temperature	
T-ambient (max.)	75 °C

T-ambient (min.)	-20 °C
T-Case maximum (max.)	80 °C
Mechanical and Housing	
Housing	Akulon S223
Approval and Application	
Approval marks	CE marking ENEC certificate
Product Data	
Full product code	697013372879600
Order product name	SN 58 T15
EAN/UPC – product	6970133728796
Order code	913710010413
SAP numerator – quantity per pack	1
Numerator – packs per outer box	48
SAP material	913710010413
SAP net weight (piece)	0.049 kg

Electronic ignitor for HID lamp circuits

Dimensional drawing

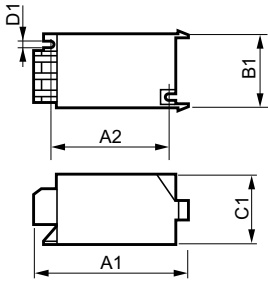

Product	C1	A1	A2	B1
SN 58 T15	38.5 mm	85.5 mm	65.0 mm	41.5 mm

SN 58 T15

